



## ILEE® LDA-HOLDER

### DESCRIPTION

To complement our LDA and LDM modules we developed a range of practical holders. The modules can be adjusted in at least two planes (except Type 0023-04). The holders are executed in different precision ranges. Each type is adjusted differently however the design allows reaching the desired position with a few simple moves.

Each holder has specific features such as the fine adjustment system or height adjustment range.

### CHARACTERISTICS

- 0023-01: Very precise fine adjustment
- 0023-02: Simple height adjustment; precise alignment; fits standard  $\varnothing 20$
- 0023-03: Wide swivel angle ( $\pm 20^\circ$ ), simple fixation
- 0023-04: Large radius adjustment ( $\pm 30^\circ$ ), made from one piece

## TECHNICAL DATA

| Criteria | X-Axis                   | Y-Axis                   | Max. number of thread rotations | Base fixation         | Module-Diameter |
|----------|--------------------------|--------------------------|---------------------------------|-----------------------|-----------------|
| 0023-01  | +0.046/−0.039rad         | +0.046/−0.039rad         | 9                               | Hexagon-bolts M6 (4x) | Ø11             |
| 0023-02  | ±0.105 rad <sup>1)</sup> | ±0.105 rad <sup>1)</sup> | 12                              | Clamp screw M5        | Ø11–15          |
| 0023-03  | 2π rad (360°)            | ±0.349rad                | –                               | Hexagon-bolts M6 (4x) | Ø11             |
| 0023-04  | ±0.524 rad               | –                        | –                               | Hexagon-bolts M6 (1x) | Ø11             |

<sup>1)</sup> Correct for diameter Ø11

## DIMENSIONS

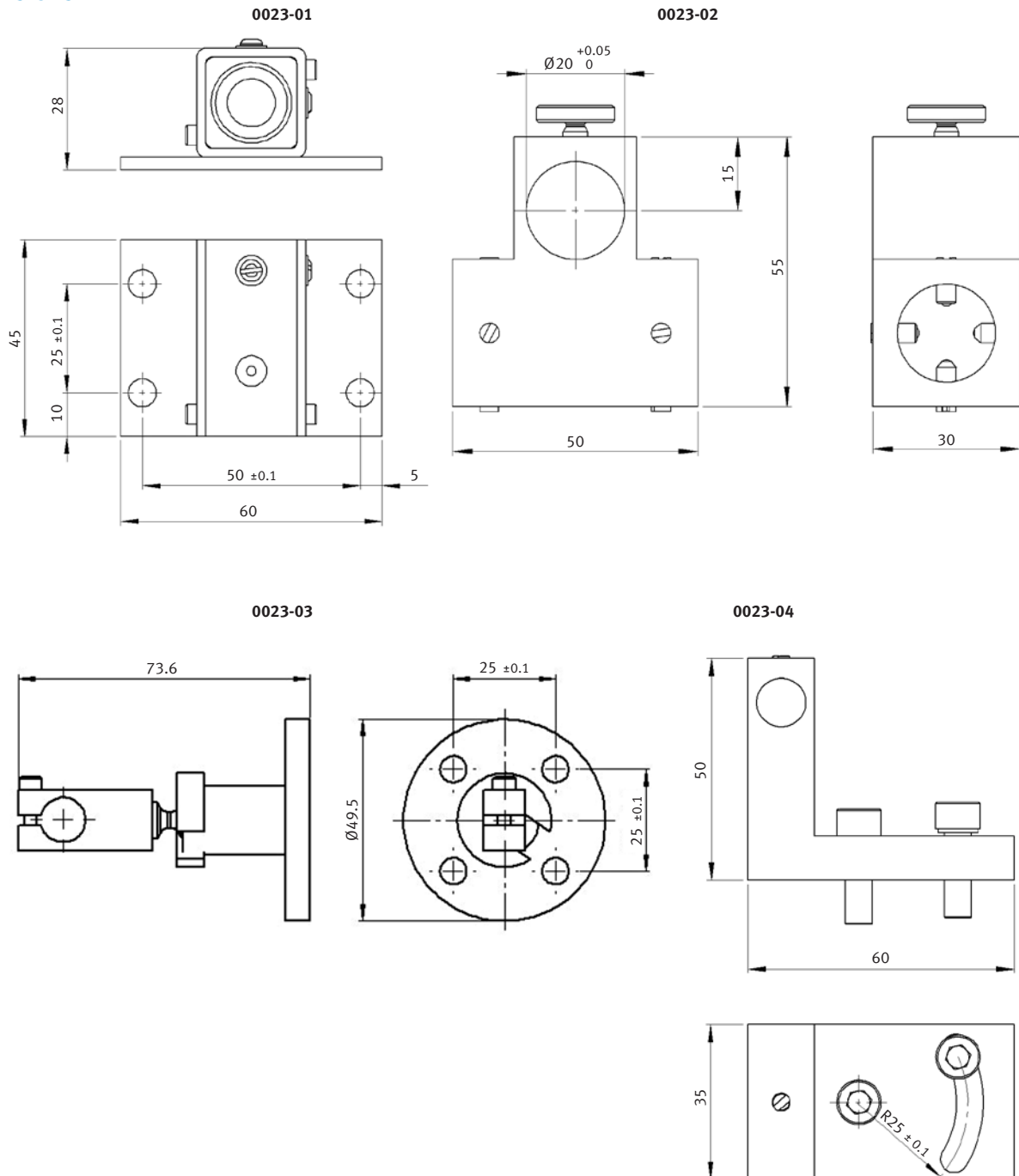

### Rheinmetall Air Defence AG

Birchstrasse 155 · CH 8050 Zurich · Switzerland · Phone +41443162211  
 lasersolutions\_rad@rheinmetall.com · www.ilee.ch

